

PCB Supports - Screw Mount Type

PFZ Series - Male M4 Thread • Low cost alternative to PBZ series • Fixes into tapped hole or fasten with a nut
Quick release locking tab

Part Number	Spacing A 1.5mm PCB	Screw Length B
05-PFZ06	6.3	4.8
05-PFZ16	15.9	4.5

Material: Nylon 6/6

Mounting Holes
PCB 4.0mm
Panel 4.0mm
(M4 Screw Clear)

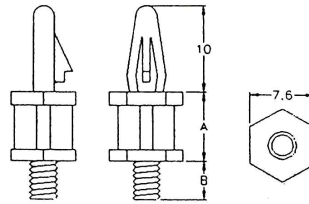

PCB Support - Key-Slot Type

For use with key hole slot and easy removal of PCB

Part Number	Spacing A 1.5mm PCB
05-PTM06	6.4
05-PYP06	6.4
05-PYP10	9.5
05-PYP13	12.7
05-PYP16	15.9

Material: Nylon 6/6



PTM
PCB Hole 4.0mm

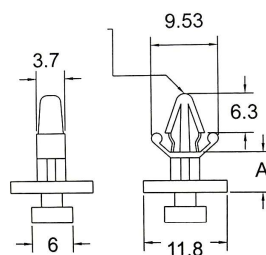

PYP
PCB Hole 4.0mm

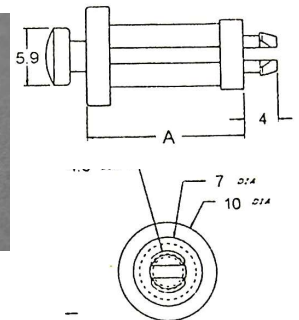

Male PCB Supports Posts - Screw Mount Type

PCZ Series • Fits into tapped hole or fasten with a nut
UNC 8-32 thread size screw length 6.35mm hole size 4mm

Part Number	Screw Length
05-PCZ06	6.35
05-PCZ10	9.53
05-PCZ13	12.7
05-PCZ16	15.9
05-PCZ19	19
05-PCZ25	25.4

Material: Nylon 6/6

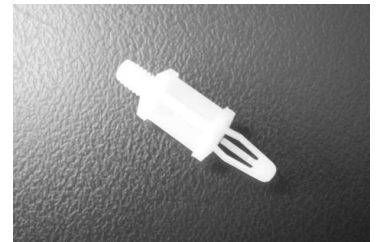
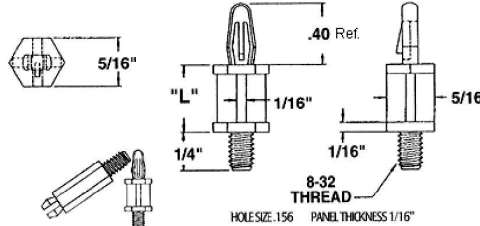

PCB Support - Slide Type

For mounting without using holes in the PCB • Panel clip and spigot for secure and accurate location

Part Number	Spacing A 1.5mm PCB
05-PUA06	6.4

Material: Nylon 6/6

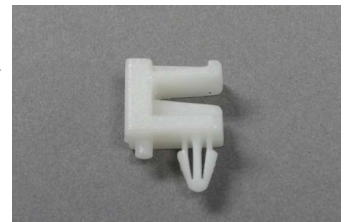
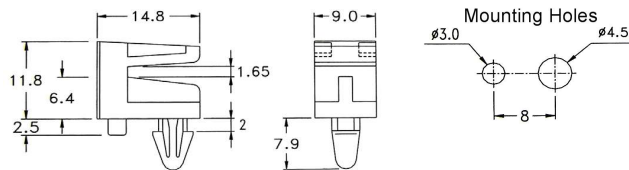

PCB Support - With Support Clip

For mounting without using holes in the PCB

Part Number	Spacing A 1.5mm PCB
05-PBP10L	9.5
05-PBP13L	12.7

Material: Nylon 6/6

Mounting Holes
PCB 4.0mm
Panel 4.8mm

