

PCB Support – Adhesive Mount

No panel holes required

PSB Series

PCB Hole 4.0mm

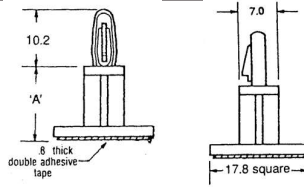

PSA Series

PCB Hole 3.0mm

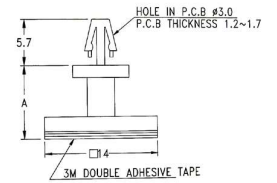

Part Number	Spacing A
05-PSB06	6.3
05-PSB10	9.5
05-PSB13	12.7
05-PSB16	15.9
05-PSB19	19.1
05-PSB25	25.4
05-PSB30	28.6

Part Number	Spacing A
05-PSA06	6.3
05-PSA09	9.0
05-PSA13	12.7

PCB Screw Support – Adhesive Mount

Low profile mount with #4 self tap screw

PASR Series

Part Number	Spacing A
05-PASR06	6.4
05-PASR11	10.8

Material: Nylon 6/6

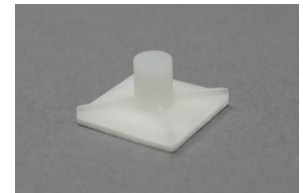
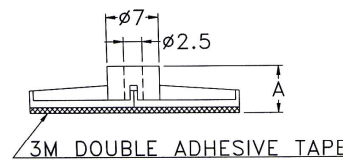
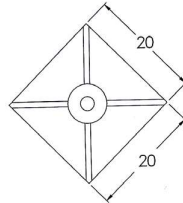

PCB Edge Support – Adhesive Mount

For mounting without holes in PCB or panel

• Spacer edge hold

PUB Series

Part Number	A	B	C
05-PUB06	11.3	2.6	6.0
05-PUB08	12.8	2.4	7.9

Material: Nylon 6/6

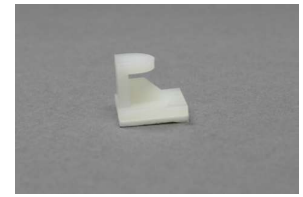
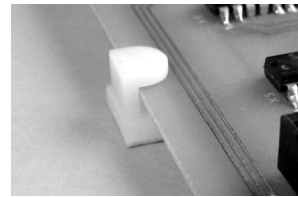
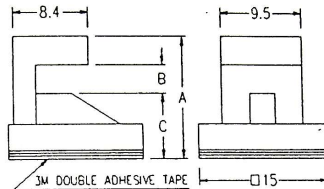

Blind Hole Mount

Flexible ribs lock into blind hole (e.g. wood panels)

Quick release locking clip

Part Number	Spacing A
05-PTB05	5.2
05-PTB09	9.5

Material: Nylon 6/6

Mounting Holes

PCB 4.0mm
Panel 8.0mm

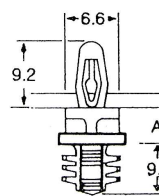

Dual Locking

Clips at each end which lock into panel thicknesses of 0.5-2.0mm

PBM Series

Part Number	Spacing A
05-PBM06	9.27
05-PBM08	10.72
05-PBM10	9.5
05-PBM13	12.7
05-PBM16	18.92
05-PBM32	34.8

Material: Nylon 6/6

Mounting Holes

4.8mm
Both ends

