

1196 – Contact Thermoplastic Knob - Male

Black thermoplastic base with cap • Cap colours – Black, orange, red, blue, yellow, and silver

- Treated threaded steel stud

Part Number	D	H	d1	d5	l
11-KPCX40S6-15	40	28	37	M6	15
11-KPCX40S6-30	40	28	37	M6	30
11-KPCX40S6-40	40	28	37	M6	40
11-KPCX40S8-15	40	28	37	M8	15
11-KPCX40S8-30	40	28	37	M8	30
11-KPCX40S8-47	40	28	37	M8	47
11-KPCX40S10-20	40	28	37	M10	20
11-KPCX40S10-30	40	28	37	M10	30
11-KPCX40S10-40	40	28	37	M10	40

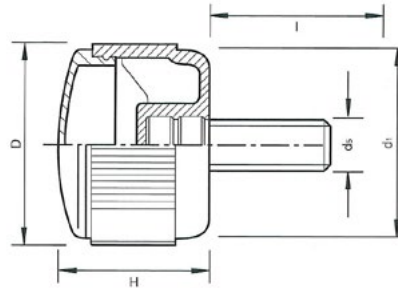

11-KPCX see below X =
 B – Black cap
 O – Orange
 R – Red
 BU – Blue
 Y – Yellow
 S – Silver

1190 – Adjustable Feet with Thru Holes

Reinforced P.A. 6, black with treated steel • Max Static Load 10.000 N (vertical stud)

Part Number	D	H	d	l	h2	d2
11-AFP80S8-45	80	27	M8	45	2	9
11-AFP80S8-70	80	27	M8	70	2	9
11-AFP80S10-45	80	27	M10	45	2	9
11-AFP80S10-70	80	27	M10	70	2	9
11-AFP80S12-45	80	27	M12	45	2	9
11-AFP80S12-70	80	27	M12	70	2	9
11-AFP80S14-70	80	27	M14	70	2	9
11-AFP80S14-120	80	27	M14	120	2	9
11-AFP80S16-70	80	27	M16	70	2	9
11-AFP80S16-120	80	27	M16	120	2	9
11-AFP80S20-100	80	27	M20	100	2	9

